

---

# AMERICANA / II POMPEII APARTMENTS

3635 / 3655 W. ARTESIA BLVD. TORRANCE, CA 90504

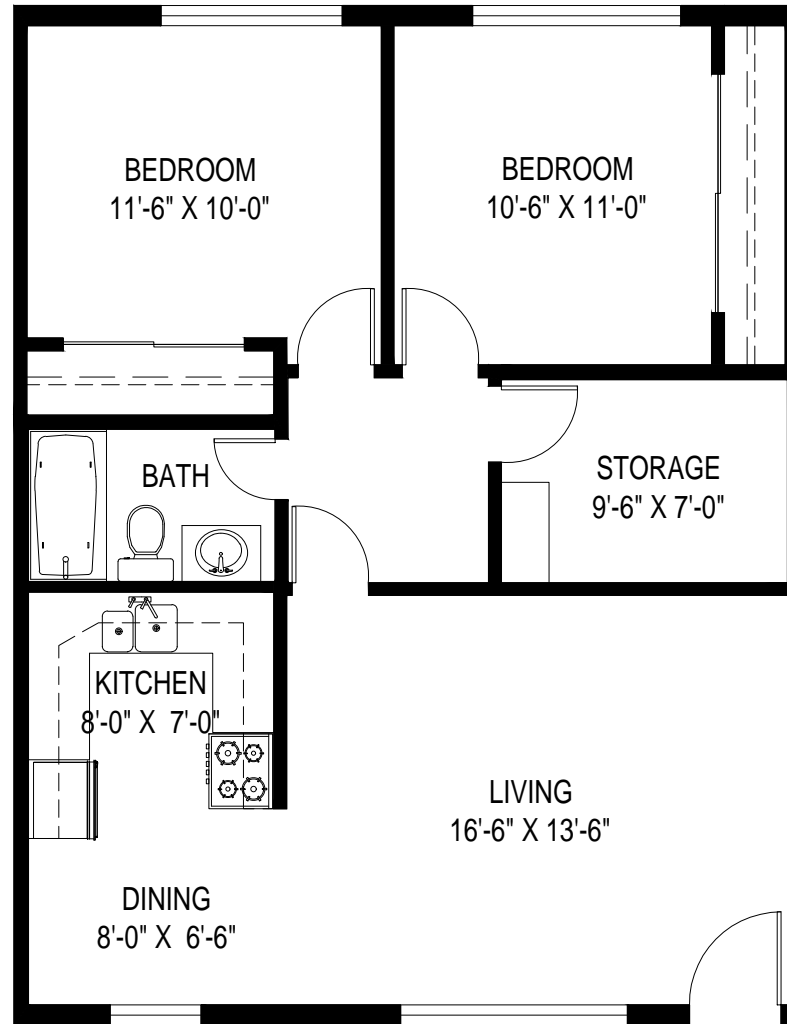

---

**LAYOUT A: 2 BED / 1 BATH**

**824 SF**

\*ROOM SIZES ARE APPROXIMATE AND FOR REFERENCE ONLY

---

Miracle Mile Properties  
 4221 Wilshire Blvd.  
 Suite 480  
 Los Angeles, CA 90010

**Americana / Il Pompeii Apartments**

3635/3655 W. Artesia Blvd.  
 Torrance, CA 90504

Property Boss &  
 AMS Utility Billing

Apartment: Unit #150-A (Layout A: 2 Bed / 1 Bath)

Room Number	Room Name	Approx. Room Dimension	Area (SF)	Flooring (SF)	Flooring (SY)	Cove / Wall Base (LF)
100	Living	16'-5" x 13'-6"	225	225	25.00	51
101	Dining	8'-6" x 6'-6"	(See Kitchen)	(See Kitchen)	(See Kitchen)	(See Kitchen)
102	Kitchen	8'-6" x 7'-1"	111	80	8.89	34
103	Bathroom	8'-1" x 5'-0"	41	25	2.78	24
104	Closet 1	8'-2" x 2'-2"	19	19	2.11	15
105	Bedroom 1	11'-8" x 10'-3"	124	124	13.78	39
106	Bedroom 2	10'-5" x 11'-2"	119	119	13.22	34
107	Closet 2	2'-0" x 11'-2"	24	24	2.67	19
108	Storage	9'-5" x 6'-8"	58	58	6.44	31
109	Hallway	6'-7" x 6'-8"	47	47	5.22	19
<b>Total Material*</b>			<b>768</b>	<b>721</b>	<b>80.11</b>	<b>266</b>
<b>Total Unit Area**</b>			<b>824</b>			

\*SF calcs are approximate based upon a single typical unit measured; must be verified in field. Flooring SF/SY/LF is for reference and does not include overage based upon material.

\*\*Unit Area excludes patio, balconies etc.. and includes interior walls.

Room sizes are approximate and for reference only.

Includes Inside Walls (measure length x width). This is what goes on the Lease.

Ritz

Ritz